

TABLEAU IMMEVBLAY

darwin art furniture makers
at 24 HR ART

November '96

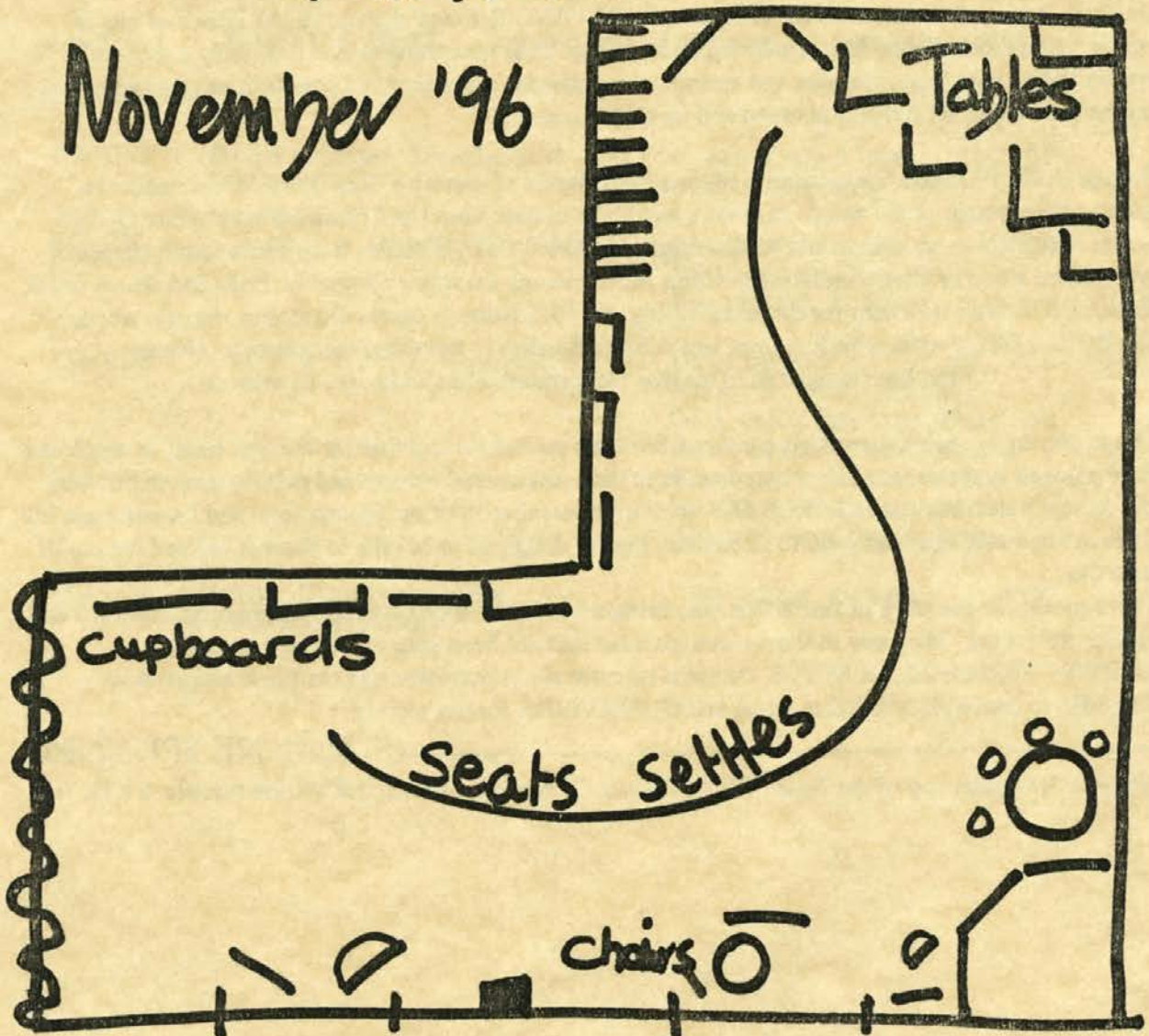

-TABLEAU IMMEUBLAY-----song---
Tableau Immeublay/ Strength & Solididity
Tableau Immeublay/ Beauty & Fragility

THANKS TO

the furniture MAKERS- Franck, Colin, Jengis, Rex, Edwin, Jim, Peter and Don

the furniture MOVERS- Don Whyte, Steve Fox, Franck Gohier, Jacki Fleet, Colin Holt

the furniture LOVERS- Jacki Fleet, Kate Fernyough, Belinda Emmerson-Whyte,
Julie Wells, Camille Kaiplinger, Claire Kilgariff, Annie Wells, Peter & Susie Adsett,
Greg Cavenagh, Jane Hanak and Burrundi Pictures

the furniture STORERS- Framed Gallery and Myilly Point Gallery

and the furniture ANIMATORS

<<<<<<CORRUGATED IRON YOUTH THEATRE >>>>>>

MUSICAL CHAIRS- performed by : LAWRENCE GRAY, CHLOE HEARD-PITCHER,
KATE MORNANE, JOANNE SHARPE, ALEX SMITH & STELLA GRAY(Cello)
DIRECTOR & MUSIC: Merrilee Mills CHOREOGRAPHY : Sarah Calver
from a CoNcEpt by Suzanne Spinner encouraged as always by Maggie Miles.

and the furniture SPONSORS - NT HANDY HIRE who lent the enormous trailer
JARDONS who lent the tiles and 24 HR ART who made the space for it all....



47 De Latour Street
Coconut Grove
Northern Territory
0810



TABLEAU IMMEUBLAY is a poetic fabrication with relevant resonances.
TABLEAU suggested Tableau Vivant, tables and imminent animation .
IMMEUBLAY is a conflation of words I thought I remembered in other languages-
immeubles (Fr.) mobil(Grm) mobile(It.) and the combination reminded me of an ad
I used to see on tv in Melbourne years ago for a particularly excessive Brunswick
furniture vendor by the name of Franco Cozzo who took as his signature tune,
Verdi's famous aria from Rigoletto, LA DONNA E MOBILE.

thanks to : The Australia Council & The NT
Office of the Arts & Cultural Affairs



Northern Territory Government
= Arts and Cultural Affairs =



NORTHERN TERRITORY CENTRE FOR CONTEMPORARY ART
GPO Box 28, DARWIN NT 0801. Viny Lane Parap Tel.: (089) 81 5368 Fax: (089) 81 5547



TABLEAU IMMEUBLAY

"Furniture can be an expression of cultural freedom...our national strengths in improvisation and black humour might well be employedwe need self-conscious design driven with aspiration and hope"

Peter Corigan: THE AUSTRALIAN CHAIR. R.I.A. (NSW) 1989

The idea of TABLEAU IMMEUBLAY is to showcase the work of some of Darwin's most interesting art furniture makers and to create an installation and performance event that animates these solid static objects which are made to be used, as well as contemplated for their satisfying forms and fine finishes. I decided to limit the furniture selected to generic categories- Tables, Seats and Cupboards, despite the fact that these artists make a variety of furniture, from bedheads to staircases. This collection of furniture is a result firstly of availability; many of the best works have been bought by furniture lovers and despatched around the world, so I have been forced to raid the maker's own collections. I chose pieces that I would be pleased to have in my house and this is reflected in the numbers of pieces borrowed from good homes around Darwin..

All these works tell a story of the Northern Territory in the idiom of this place. They are made from local materials - including Ironwood and other native timbers, or of materials brought here, used here and left here like steel and ripple iron, materials that can withstand the termites and the climate, survivor materials. Materials can find their way here inadvertently as flotsam and jetsam brought by the high tides of the wet and washed up around the harbour, picked up beaches or discovered tangled in the mangroves. Others are from impounded refugee boats and confiscated Indonesian fishing boats. Some materials are discarded at abandoned sites, dumped at the tip, or salvaged from demolition work .

Luckily for us, all these artists are compulsive SCAVANGERS and chronic HOARDERS of bits of things that might be made into something else one day. That something else is invariably a thing of beauty with a new found purpose and meaning; its potential is revealed, its possibilities re-invented, its patina uncovered, its surfaces restored and its shapes remade.

Franck GOHIER shows the resonance of time in the layers of narrative, Rex MAXWELL makes us aware of the weight of the wood, its sinews and limbs in dark blood and bleached bone. Peter QUINN writes with steel in an elegant and witty calligraphy. Don WHYTE frames from dense Jarrah images of sea washed wood or silvery aluminium. Colin HOLT retains the forms of what he finds and resists finish. Edwin RIDE finds new uses for discarded utility. JENGIS Isdianto carves old stories into old woods. Jim SCHOFIELD works with fine lines and delicate finishes to describes the spaces in between.

It has been suggested to me that the furniture even looks like its makers!

I hope you enjoy seeing these forty pieces of furniture assembled together for the first time, as much as I have enjoyed finding them, extracting them from their makers and owners and putting them in this very big lounge room that is 24 HR ART. This exhibition was dreamt of by Thelma John and I a while ago but Thelma ran out of time and went to Fremantle, but I'm delighted to be able to show it before I ran out of time too...

These pieces are the work of fine artists who bring a bounty of improvisation, imagination, craft, wit and skill to their work. They saw in these materials what had not been seen before, and created a DARWIN VERNACULAR STYLE that tells us more about ourselves and our place and gives us TABLES to dance on, SEATS to sit on and CUPBOARDS for our secrets.

-----SUZANNE SPUNNER

Notes: CA =Collection of the Artist PCD = Private Collection, Darwin NFS= Not for sale \$ = for sale

PETER QUINN-----

Born 1954, Melbourne

Arrived Darwin: just prior to Cyclone Tracy stayed a few weeks; passed through again in 1982 and stayed nearly two years. Came back a year or so later and stayed.

Began making furniture: I have made furniture for as long as I can remember. Even as a small child I worked alongside my father, an ex-farmer, who was always making something in the garage.

I find the idea of making something from nothing very attractive. I find the idea of making something that works in more than one way, or on more than one level, also appealing. A beautiful chair is a seat with a secret life.

I do not consider myself a maker of furniture. Rather I make "stuff"...all sorts of things from all sorts of materials. Sometimes the very sharp constraints of function are as stimulating as those of form...this can lead to furniture.

I make one-off pieces. I like steel and wood, particularly found timber and used steel, because of their ability to suggest their own destiny. The nature of available materials is for me a powerful stimulus, quite as important as more theoretical ideas about form and function. Nonferrous Scrap Metal has at times been my spiritual home." PETER QUINN

Contact: 5 Stone Place Rapid Creek PH: 8985 6500

TABLES

PQ-T1	Cafe table	concrete top welded steel base	CA
-------	------------	-----------------------------------	----

CHAIRS

PQ-C1	Female	welded steel	CA
PQ-C2	Peace	welded steel	CA
PQ-C3	Snake	welded steel	CA
PQ-C4	Wiggle	welded steel	CA
PQ-C5	Cross	welded steel	CA

SEATS

PQ-S1	Peacock	welded Steel	CA
PQ-S2	Empire	welded Steel	CA
PQ-S3	Sonic wave	welded steel	CA
PQ-S4	Glenferrie Station	Copper pipes found timber splatter painted	CA

BENCHES

PQ-B1	Sea Bench	found timber & welded steel	CA
-------	-----------	--------------------------------	----

-TABLEAU IMMEUBLAY-----song---
Tableau Immeublay/ Strength & Solididity
Tableau Immeublay/ Beauty & Fragility

THANKS TO

the furniture MAKERS- Franck, Colin, Jengis, Rex, Edwin, Jim, Peter and Don

the furniture MOVERS- Don Whyte, Steve Fox, Franck Gohier, Jacki Fleet, Colin Holt

the furniture LOVERS- Jacki Fleet, Kate Fernyough, Belinda Emmerson-Whyte,
Julie Wells, Camille Kaiplinger, Claire Kilgariff, Annie Wells, Peter & Susie Adsett,
Greg Cavenagh, Jane Hanak and Burrundi Pictures

the furniture STORERS- Framed Gallery and Myilly Point Gallery

and the furniture ANIMATORS

<<<<<<CORRUGATED IRON YOUTH THEATRE >>>>>>

MUSICAL CHAIRS- performed by : LAWRENCE GRAY, CHLOE HEARD-PITCHER,
KATE MORNANE ,JOANNE SHARPE, ALEX SMITH & STELLA GRAY(Cello)
DIRECTOR & MUSIC: Merrilee Mills CHOREOGRAPHY : Sarah Calver
from a CoNcEpt by Suzanne Spinner encouraged as always by Maggie Miles.

and the furniture SPONSORS - NT HANDY HIRE who lent the enormous trailer
JARDONS who lent the tiles and 24 HR ART who made the space for it all....



47 De Latour Street
Coconut Grove
Northern Territory
0810



TABLEAU IMMEUBLAY is a poetic fabrication with relevant resonances.
TABLEAU suggested Tableau Vivant, tables and imminent animation .
IMMEUBLAY is a conflation of words I thought I remembered in other languages-
immeubles (Fr.)mobil(Grm) mobile(It.) and the combination reminded me of an ad
I used to see on tv in Melbourne years ago for a particularly excessive Brunswick
furniture vendor by the name of Franco Cozzo who took as his signature tune,
Verdi's famous aria from Rigoletto, LA DONNA E MOBILE.

thanks to : The Australia Council & The NT
Office of the Arts & Cultural Affairs



Northern Territory Government
= Arts and Cultural Affairs =



NORTHERN TERRITORY CENTRE FOR CONTEMPORARY ART
GPO Box 28, DARWIN NT 0801, Vimy Lane Parap Tel: (089) 81 5368 Fax: (089) 81 5547





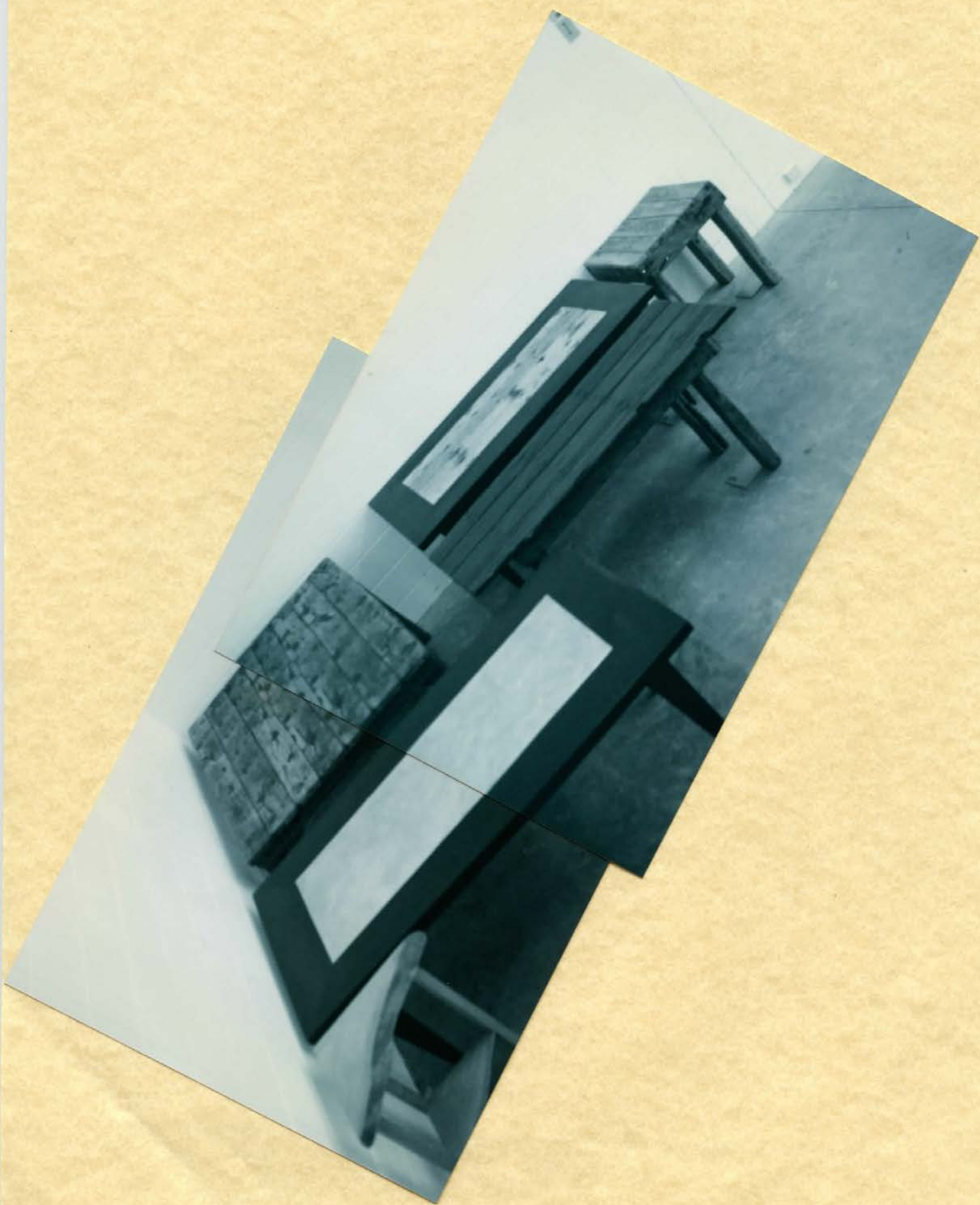

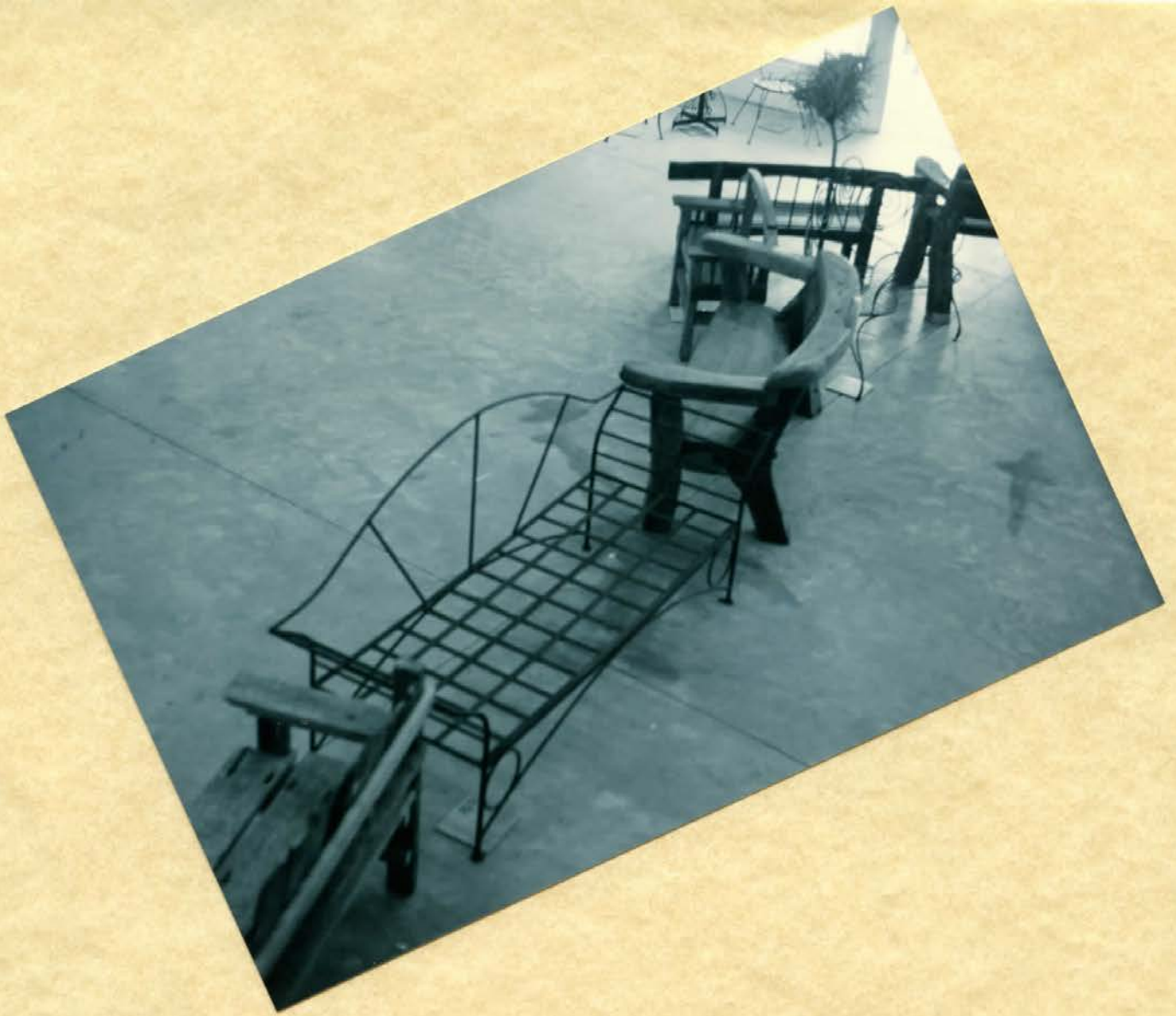





-----TABLEAU IMMEUBLAY-----
Tableau Immeublay/ Strength & Solididity
Tableau Immeublay/ Beauty & Fragility



PERFORMANCE Notes: Actions and Images
Punctuation and cue for action from music or text line

Using the furniture normally and naturally
using it unnaturally

- all hiding far up and under the tables
- a hiding place for themselves
- a displaying place for themselves
- a hiding place for an object
- a display place for an object
- all sitting up properly on chairs and seats contrast with
- all lounging on same
- choosing a favourite chair / seat / table/ cupboard
- indicating desire for and pleasure in the item of furniture
- claiming a chair
- taking up as much space on a chair etc
- taking up as little space
- responding to the particular quality of a piece of furniture- its texture / shape etc....
- making music from the furniture

All singing Il Donne a mobile????



you are invited to the opening of

TABLEAU IMMEUBLAY

a retrospective of DARWIN ART FURNITURE MAKERS
curated by Suzanne Spinner

on WED 27 NOVEMBER at 6PM

featuring chairs/tables/cupboards/settles/dressers et al
by Franck Gohier/ Colin Holt/Rex Maxwell/ Peter Quinn/
Jim Schofield /Don Whyte

at 24 HR ART for one week only WED 27 until SAT 30

Performance of Musical Chairs by Corrugated Iron Youth Theatre
on Wed 27 at 6.30 pm and Sat 30 at 12 noon



TEXT Notes;

The text could be on cards which they pick up or on butchers paper or written on the wall or floor in chalk

Dont' touch

Be careful of the furniture

Don't rock on the chair

Sit up Straight

Lay the table

Don't lounge all over it

Elbows off the table

Who left this here?

Put that away

Clear the table

Don't climb on that

Polish the furniture

Wipe the table

Whose is this?

How did these get here?

You'll knock something over doing that

Were you dancing on the table?

You can't do that on that!

Whose been sitting on my chair?

Stop drumming on the table

Sit down

Oh who did this?

Oh who did this? It's beautiful

I've been sitting here for ages

Ages -five years at least

At least we can sit down

Sit down here, please

